

DURHAM AND SOUTHERN RAILROAD

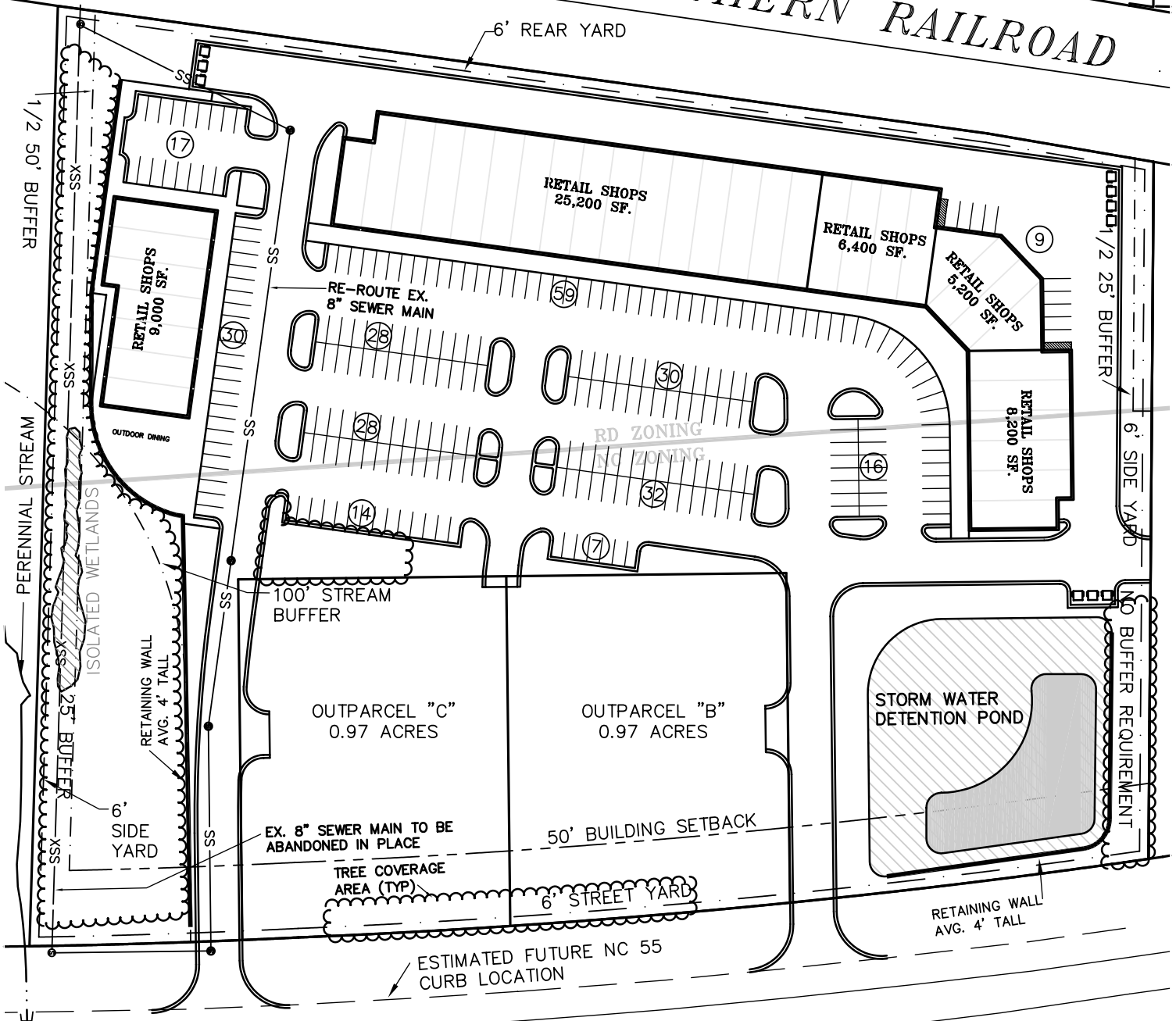

SHOPPING CENTER: 7.47 ACRES IMPERVIOUS AREA: 66%
 OUTPARCEL B: 0.97 ACRES
 OUTPARCEL C: 0.97 ACRES

SHOPPING CENTER: 54,000 SF
 PARKING REQUIRED: 270 SPACES
 PARKING PROVIDED: 270 SPACES

TREE COVERAGE AREA REQUIRED: 11%
 TREE COVERAGE AREA PROVIDED: 12%

USABLE AREAS
 HIGH GROUND: 8.31 ACRES
 TOTAL UNUSABLE: 1.10 ACRES

TOTAL SITE: 9.41 ACRES

GRAPHIC SCALE



(IN FEET)
 1 inch = 100 ft.

JUNE 26, 2004